

Name: 2s-25-1n
Type: Gate valves -2s type
Subtype: Medium parameters valves
Operating medium: water-steam
Body material: 20ГЦЛ

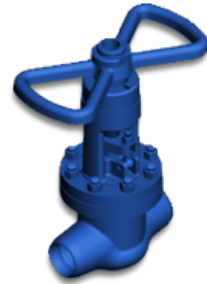

DESCRIPTION:

Gate valves are designed for water and steam lines leak-free shutoff. These valves can be applied only for full valve opening or shutoff. Gate valves can't be used as control valves

TECHNICAL DATA:

Diameter, DN: 150 mm
Pressure, PN: 6.3 MPa
Temperature: 425 C
Hydraulic resistance coefficient: 0.8
Rotational moment on the shaft: 290 Ngm
Number of revolutions: 21
Operating stroke: 126 mm

DIMENSIONS:

D1: 147 mm
D2: 160 mm
L: 450 mm
H: 661 mm
A: 148 mm
Weight (w/o actuator): 0 kg
Weight (with actuator): 205 kg

ACTUATOR:

Control type: M
Actuator model: -
Actuator power: - kW
Full stroke time: - s

DIMENSIONAL DRAWING:

