

**Name:** 2s-35-1  
**Type:** Gate valves -2s type  
**Subtype:** Medium parameters valves  
**Operating medium:** water-steam  
**Body material:** 20ГЦЛ

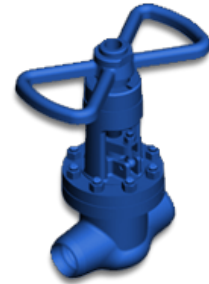

#### DESCRIPTION:

Gate valves are designed for water and steam lines leak-free shutoff. These valves can be applied only for full valve opening or shutoff. Gate valves can't be used as control valves

#### TECHNICAL DATA:

Diameter, DN: 80 mm  
Pressure, PN: 6.3 MPa  
Temperature: 425 C  
Hydraulic resistance coefficient: 1  
Rotational moment on the shaft: 200 Ngm  
Number of revolutions: 15.4  
Operating stroke: 92 mm

#### DIMENSIONS:

D1: 81 mm  
D2: 90 mm  
L: 350 mm  
H: 488 mm  
A: 103 mm  
Weight (w/o actuator): 0 kg  
Weight (with actuator): 74 kg

#### ACTUATOR:

Control type: M  
Actuator model: -  
Actuator power: - kW  
Full stroke time: - s

#### DIMENSIONAL DRAWING:

