

Name: 2s-35-2
Type: Gate valves -2s type
Subtype: Medium parameters valves
Operating medium: water-steam
Body material: 20ГЦЛ

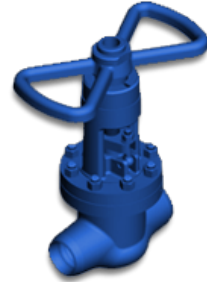

DESCRIPTION:

Gate valves are designed for water and steam lines leak-free shutoff. These valves can be applied only for full valve opening or shutoff. Gate valves can't be used as control valves

TECHNICAL DATA:

Diameter, DN: 100 mm
Pressure, PN: 6.3 MPa
Temperature: 425 C
Hydraulic resistance coefficient: 0.86
Rotational moment on the shaft: 200 Ngm
Number of revolutions: 15.4
Operating stroke: 92 mm

DIMENSIONS:

D1: 97 mm
D2: 111 mm
L: 350 mm
H: 488 mm
A: 103 mm
Weight (w/o actuator): 0 kg
Weight (with actuator): 74 kg

ACTUATOR:

Control type: M
Actuator model: -
Actuator power: - kW
Full stroke time: - s

DIMENSIONAL DRAWING:

