

Type: Steam boilers
Model: KE type (bituminous / brown coal)
Name: KE-16-14-250 NTKS
Alias names: KE-16-14-250 НТКС с топкой кипящего слоя, E-16-1,4-250С
Fuel: bituminous / brown coal

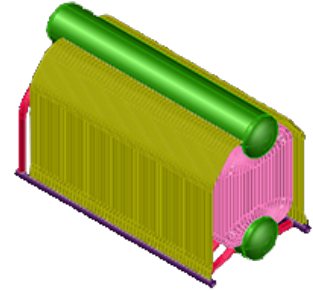

DESCRIPTION:

Steam boilers of this type are designed for production of saturated or overheated steam for needs of different industries, heating, ventilation and hot-water supply systems.

TECHNICAL DATA:

Steam capacity: 16.0 t/h
Output pressure: 1.3 (12,5) Pa (kp/cm²)
Output temperature: 250 C
Supply water temperature: 100 C
Efficiency: 89 %
Fuel consumption: 4921 kg/h

DIMENSIONS:

Integrated boiler dimensions: 10906x6486x 12027 mm
Weight: 85400 kg