

**Type:** Steam boilers  
**Model:** KE type (bituminous / brown coal)  
**Name:** KE-25-24-350  
**Alias names:** KE-25-24-350, E-25-2,4-350БФ ФКК  
**Fuel:** bituminous / brown coal

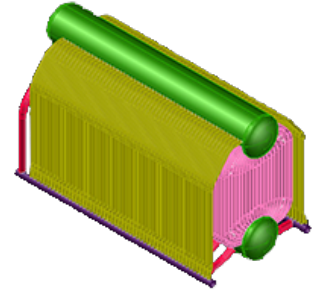

## DESCRIPTION:

Steam boilers of this type are designed for production of saturated or overheated steam for needs of different industries, heating, ventilation and hot-water supply systems.

## TECHNICAL DATA:

Steam capacity: 25.0 t/h  
Output pressure: 2.3 (23) Pa (kp/cm<sup>2</sup>)  
Output temperature: 350 C  
Supply water temperature: 100 C  
Efficiency: 86,7 %  
Fuel consumption: 4280 kg/h

## DIMENSIONS:

Integrated boiler dimensions: 13500x5610x 8575 mm  
Weight: н/д kg