

Type: Steam boilers
Model: KE type (bituminous / brown coal)
Name: KE-4-14S-O
Alias names: KE-4-14C-O, E-4-1,4P
Fuel: bituminous / brown coal

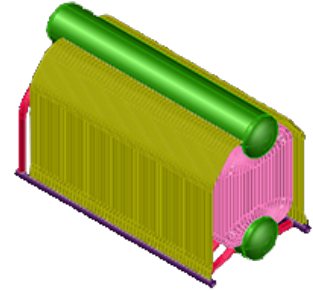

DESCRIPTION:

Steam boilers of this type are designed for production of saturated or overheated steam for needs of different industries, heating, ventilation and hot-water supply systems.

TECHNICAL DATA:

Steam capacity: 4.0 t/h
Output pressure: 1.3 (13) Pa (kp/cm²)
Output temperature: 194 C
Supply water temperature: 100 C
Efficiency: 80,8 %
Fuel consumption: 458/895 kg/h

DIMENSIONS:

Integrated boiler dimensions: 6900x4640x 5190 mm
Weight: 15700 kg