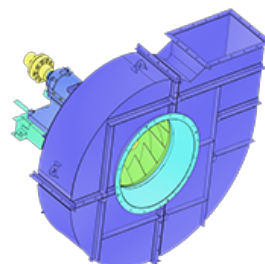

Name: FDF-15.5-1500-FC**Russian name:** ВД-15,5Ф-1500К**Type:** Single inlet centrifugal forced flow fans**Notes:** Forward curved blades

DESCRIPTION:

Single inlet forced-flow fan are intended to be used for air delivery into combustion chamber of boilers. The main parts of such type of fans are: running wheel, guide vanes, scroll case, inlet bell, electric motor, base.

AERODYNAMIC PERFORMANCE:

Capacity: 135.0 ths. m³

Total pressure: 16800 Pa

Temperature: 100 C

Efficiency: 73 %

Dustiness: 0.1 g/m³

DIMENSIONS:

Length: 2932 mm

Width: 2397 mm

Height: 2709 mm

Weight: 3090 kg

ELECTRIC MOTOR:

Power: 1000 kW

Rate speed: 1500 rpm

Moment of inertia: 220 kg*m²

AUXILIARIES:

Actuator: 1600 Hm

DELIVERY OPTIONS:

Railway: Flatcar: 1 | Open wagon: 0 | Schnabel car: 0

DIMENSIONAL DRAWING:

