

Name: FDF-15.5C

Russian name: ВД-15,5К

Type: Single inlet centrifugal forced flow fans

Notes: Forward curved blades

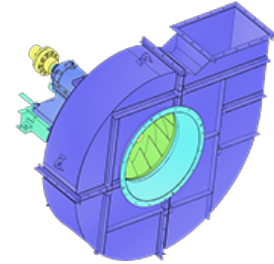

DESCRIPTION:

Single inlet forced-flow fan are intended to be used for air delivery into combustion chamber of boilers. The main parts of such type of fans are: running wheel, guide vanes, scroll case, inlet bell, electric motor, base.

AERODYNAMIC PERFORMANCE:

Capacity: 90.0 ths. m³

Total pressure: 6625 Pa

Temperature: 100 C

Efficiency: 72 %

Dustiness: 0.1 g/m³

DIMENSIONS:

Length: 2411 mm

Width: 2725 mm

Height: 2900 mm

Weight: 2304 kg

ELECTRIC MOTOR:

Power: 250 kW

Rate speed: 1000 rpm

Moment of inertia: 148 kg*m²

AUXILIARIES:

Actuator: 1600 Hm

DELIVERY OPTIONS:

Railway: Flatcar: 1 | Open wagon: 0 | Schnabel car: 0

DIMENSIONAL DRAWING:

