

**Name:** FDF-2.7-3000

**Russian name:** ВД-2,7-3000

**Type:** Single inlet centrifugal forced flow fans

**Notes:** Forward curved blades. Running wheel on the electric motor shaft.

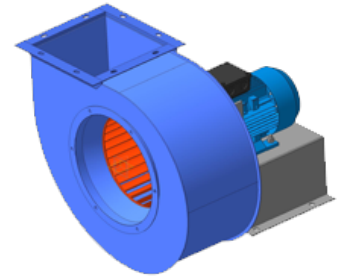

## DESCRIPTION:

Single inlet forced-flow fan are intended to be used for air delivery into combustion chamber of boilers.

## AERODYNAMIC PERFORMANCE:

Capacity: 1.1 ths. m<sup>3</sup>

Total pressure: 1500 Pa

Temperature: 70 C

Efficiency: 65 %

Dustiness: 0.1 g/m<sup>3</sup>

## DIMENSIONS:

Length: 420 mm

Width: 393 mm

Height: 569 mm

Weight: 40 kg

## ELECTRIC MOTOR:

Power: 1,5 kW

Rate speed: 3000 rpm

Moment of inertia: н/д kg\*m<sup>2</sup>

## AUXILIARIES:

Actuator: н/д Нм

## DELIVERY OPTIONS:

Railway: Flatcar: 1 | Open wagon: 0 | Schnabel car: 0

## DIMENSIONAL DRAWING:

