

Name: FDF-2.8-3000

Russian name: ВД-2,8-3000

Type: Single inlet centrifugal forced flow fans

Notes: Forward curved blades. Running wheel on the electric motor shaft.

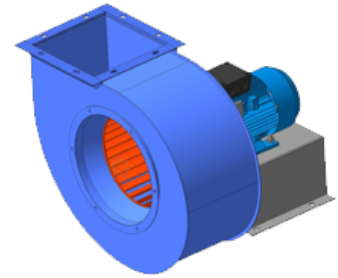

DESCRIPTION:

Single inlet forced-flow fan are intended to be used for air delivery into combustion chamber of boilers.

AERODYNAMIC PERFORMANCE:

Capacity: 2.6 ths. m³

Total pressure: 2800 Pa

Temperature: 70 C

Efficiency: 62 %

Dustiness: 0.1 g/m³

DIMENSIONS:

Length: 860 mm

Width: 810 mm

Height: 580 mm

Weight: 80 kg

ELECTRIC MOTOR:

Power: 7,5 kW

Rate speed: 3000 rpm

Moment of inertia: н/д kg*m²

AUXILIARIES:

Actuator: н/д Нм

DELIVERY OPTIONS:

Railway: Flatcar: 1 | Open wagon: 0 | Schnabel car: 0

DIMENSIONAL DRAWING:

