

Name: FDFB-15-RG-1000

Russian name: ВДН-15Х-1000

Type: Single inlet centrifugal FD fans of FDFB type

Notes: Backward curved blades

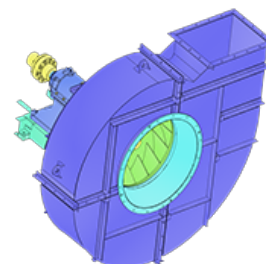

DESCRIPTION:

Single inlet centrifugal FD Fans are used for air delivery into combustion chambers of boilers with the capacity of 2.5- 950 t/h operating with balanced draft (secondary blast). It is allowed to use these fans in processing systems to handle air with the temperature not more than 70 °C. Single inlet centrifugal FD Fans can have right-hand or left-hand rotational direction. The right-hand rotation is in a clockwise order and it should be defined at electric motor side. The blades of impeller are backward curved.

AERODYNAMIC PERFORMANCE:

Capacity: 51.0 ths. m³

Total pressure: 3930 Pa

Temperature: 30 C

Efficiency: 84 %

Dustiness: 0.1 g/m³

DIMENSIONS:

Length: 3595 mm

Width: 2710 mm

Height: 2220 mm

Weight: 2850 kg

ELECTRIC MOTOR:

Power: 75 kW

Rate speed: 1000 rpm

Moment of inertia: 102,5 kg*m²

AUXILIARIES:

Actuator: 630 Hm

DELIVERY OPTIONS:

Railway: Flatcar: 1 | Open wagon: 0 | Schnabel car: 0

DIMENSIONAL DRAWING:

