

Name: IDF-13.5-OG
Russian name: Д-13,5ГМ
Type: Single inlet centrifugal ID fans of IDF type
Notes: Forward curved blades

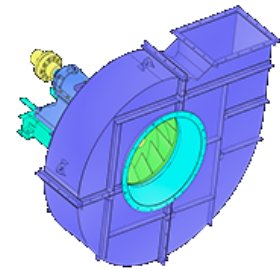

DESCRIPTION:

High-pressure single and double inlet ID Fans with forward-curved blades are designed for flue gas removal from combustion chambers of steam boilers with the capacity of up to 640 t/h with increased resistance of flue gas path. It is also allowed to install such ID Fans in processing systems for handling compatible gases (The dustiness should be not more than 2 g/m³, abrasion and sticking tendency should be similar to ashed flue gases). Also these fans are recommended to handle gases containing trace elements with sticking tendency. High-pressure single and double inlet ID Fans can have right-hand or left-hand rotational direction. The right-hand rotation is in a clockwise order and it should be defined at electric motor side.

AERODYNAMIC PERFORMANCE:

Capacity: 59.0 ths. m³
Total pressure: 3965 Pa
Temperature: 250 C
Efficiency: 72 %
Dustiness: 2.0 g/m³

DIMENSIONS:

Length: 2545 mm
Width: 2390 mm
Height: 2145 mm
Weight: 2170 kg

ELECTRIC MOTOR:

Power: 110 kW
Rate speed: 1000 rpm
Moment of inertia: 97 kg*m²

AUXILIARIES:

Actuator: 250 Hm

DELIVERY OPTIONS:

Railway: Flatcar: 1 | Open wagon: 0 | Schnabel car: 0

DIMENSIONAL DRAWING:

