

Name: IDF-15.5-OG

Russian name: Д-15,5ГМ

Type: Single inlet centrifugal ID fans of IDF type

Notes: Forward curved blades

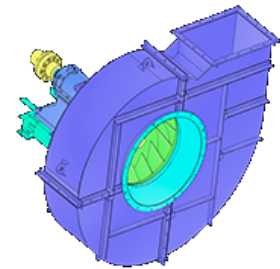

DESCRIPTION:

High-pressure single and double inlet ID Fans with forward-curved blades are designed for flue gas removal from combustion chambers of steam boilers with the capacity of up to 640 t/h with increased resistance of flue gas path. It is also allowed to install such ID Fans in processing systems for handling compatible gases (The dustiness should be not more than 2 g/m³, abrasion and sticking tendency should be similar to ashed flue gases). Also these fans are recommended to handle gases containing trace elements with sticking tendency. High-pressure single and double inlet ID Fans can have right-hand or left-hand rotational direction. The right-hand rotation is in a clockwise order and it should be defined at electric motor side.

AERODYNAMIC PERFORMANCE:

Capacity: 90.0 ths. m³

Total pressure: 4833 Pa

Temperature: 250 C

Efficiency: 72 %

Dustiness: 2.0 g/m³

DIMENSIONS:

Length: 2630 mm

Width: 2725 mm

Height: 2385 mm

Weight: 2 340 kg

ELECTRIC MOTOR:

Power: 200 kW

Rate speed: 1000 rpm

Moment of inertia: 155 kg*m²

AUXILIARIES:

Actuator: 630 Hm

DELIVERY OPTIONS:

Railway: Flatcar: 1 | Open wagon: 0 | Schnabel car: 0

DIMENSIONAL DRAWING:

