

**Name:** IDF-18-OG

**Russian name:** Д-18ГМ

**Type:** Single inlet centrifugal ID fans of IDF type

**Notes:** Forward curved blades

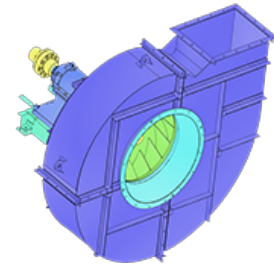

## DESCRIPTION:

High-pressure single and double inlet ID Fans with forward-curved blades are designed for flue gas removal from combustion chambers of steam boilers with the capacity of up to 640 t/h with increased resistance of flue gas path. It is also allowed to install such ID Fans in processing systems for handling compatible gases (The dustiness should be not more than 2 g/m<sup>3</sup>, abrasion and sticking tendency should be similar to ashed flue gases). Also these fans are recommended to handle gases containing trace elements with sticking tendency. High-pressure single and double inlet ID Fans can have right-hand or left-hand rotational direction. The right-hand rotation is in a clockwise order and it should be defined at electric motor side.

## AERODYNAMIC PERFORMANCE:

Capacity: 106.0 ths. m<sup>3</sup>

Total pressure: 4023 Pa

Temperature: 250 C

Efficiency: 72 %

Dustiness: 2.0 g/m<sup>3</sup>

## DIMENSIONS:

Length: 3120 mm

Width: 3130 mm

Height: 2780 mm

Weight: 4 000 kg

## ELECTRIC MOTOR:

Power: 200 kW

Rate speed: 750 rpm

Moment of inertia: 385 kg\*m<sup>2</sup>

## AUXILIARIES:

Actuator: 630 Hm

DELIVERY OPTIONS:

Railway: Flatcar: 1 | Open wagon: 0 | Schnabel car: 0

DIMENSIONAL DRAWING:

