

Name: IDF-3.5-400

Russian name: Д-3,5-400

Type: Single inlet centrifugal ID fans of IDF type

Notes: Forward curved blades. Running wheel on the electric motor shaft.

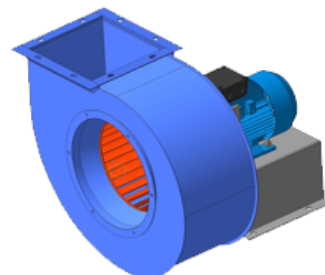

DESCRIPTION:

Single inlet centrifugal ID Fans with impeller diameter of 0.35 m are designed for flue gas removal from combustion chambers of 1 t/h steam boilers operating with balanced draft and without ash catchers. The main units of these Fans are: running wheel, scroll casing, electric motor and base.

AERODYNAMIC PERFORMANCE:

Capacity: 4.3 ths. m³

Total pressure: 450 Pa

Temperature: 400 C

Efficiency: 63 %

Dustiness: 2.0 g/m³

DIMENSIONS:

Length: 705 mm

Width: 585 mm

Height: 690 mm

Weight: 64 kg

ELECTRIC MOTOR:

Power: 3 kW

Rate speed: 1500 rpm

Moment of inertia: н/д kg*m²

AUXILIARIES:

Actuator: н/д Нм

DELIVERY OPTIONS:

Railway: Flatcar: 1 | Open wagon: 0 | Schnabel car: 0

DIMENSIONAL DRAWING:

