

Name: IDFB-13-1000

Russian name: ДН-13-1000

Type: Single inlet centrifugal ID fans of IDFB type

Notes: Backward curved blades. Running wheel on the electric motor shaft.

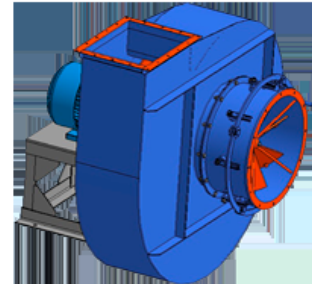

DESCRIPTION:

Single inlet centrifugal ID Fans are intended to be used for flue gas removal from combustion chambers of solid fuel or gas-and-oil-fired boilers equipped with dry ash catchers. It is allowed to install such ID Fans in processing systems for handling compatible gases (The dustiness should be not more than 2 g/m³, abrasion and sticking tendency should be similar to ashed flue gases). Such ID Fans can be applied for single or serial-parallel operation. Double inlet centrifugal ID Fans can have right-hand or left-hand rotational direction. The right-hand rotation is in a clockwise order and it should be defined at electric motor side. The blades of impeller are backward curved.

AERODYNAMIC PERFORMANCE:

Capacity: 29.0 ths. m³

Total pressure: 1870 Pa

Temperature: 200 C

Efficiency: 83 %

Dustiness: 2.0 g/m³

DIMENSIONS:

Length: 1730 mm

Width: 2270 mm

Height: 1960 mm

Weight: 1305 kg

ELECTRIC MOTOR:

Power: 30 kW

Rate speed: 1000 rpm

Moment of inertia: 55 kg*m²

AUXILIARIES:

Actuator: 250 Hm

DELIVERY OPTIONS:

Railway: Flatcar: 1 | Open wagon: 0 | Schnabel car: 0

DIMENSIONAL DRAWING:

