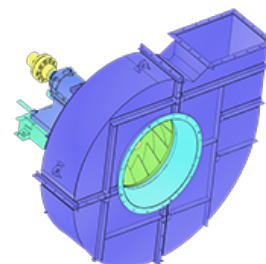

Name: IDFB-22-C-OG**Russian name:** ДН-22КГМ**Type:** Single inlet centrifugal ID fans of IDFB type**Notes:** Backward curved blades

DESCRIPTION:

Single inlet centrifugal ID Fans are intended to be used for flue gas removal from combustion chambers of solid fuel or gas-and-oil-fired boilers equipped with dry ash catchers. It is allowed to install such ID Fans in processing systems for handling compatible gases (The dustiness should be not more than 2 g/m³, abrasion and sticking tendency should be similar to ashed flue gases). Such ID Fans can be applied for single or serial-parallel operation. Double inlet centrifugal ID Fans can have right-hand or left-hand rotational direction. The right-hand rotation is in a clockwise order and it should be defined at electric motor side. The main units of Single inlet centrifugal ID Fan are: running wheel, running gear, scroll casing, inlet bell and axial guide vanes. The blades of impeller are backward curved.

AERODYNAMIC PERFORMANCE:

Capacity: 160.0 ths. m³

Total pressure: 3050 Pa

Temperature: 250 C

Efficiency: 84 %

Dustiness: 2.0 g/m³

DIMENSIONS:

Length: 3390 mm

Width: 4390 mm

Height: 3430 mm

Weight: 5980 kg

ELECTRIC MOTOR:

Power: 200 kW

Rate speed: 750 rpm

Moment of inertia: 750 kg*m²

AUXILIARIES:

Actuator: 630 Hm

DELIVERY OPTIONS:

Railway: Flatcar: 1 | Open wagon: 0 | Schnabel car: 0

DIMENSIONAL DRAWING:

