

**Name:** IDFB-26-C

**Russian name:** ДН-26

**Type:** Single inlet centrifugal ID fans of IDFB type

**Notes:** Backward curved blades

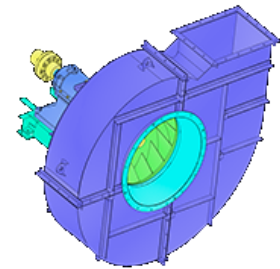

## DESCRIPTION:

Single inlet centrifugal ID Fans are intended to be used for flue gas removal from combustion chambers of solid fuel or gas-and-oil-fired boilers equipped with dry ash catchers. It is allowed to install such ID Fans in processing systems for handling compatible gases (The dustiness should be not more than 2 g/m<sup>3</sup>, abrasion and sticking tendency should be similar to ashed flue gases). Such ID Fans can be applied for single or serial-parallel operation. Double inlet centrifugal ID Fans can have right-hand or left-hand rotational direction. The right-hand rotation is in a clockwise order and it should be defined at electric motor side. The main units of Single inlet centrifugal ID Fan are: running wheel, running gear, scroll casing, inlet bell and axial guide vanes. The blades of impeller are backward curved.

## AERODYNAMIC PERFORMANCE:

Capacity: 263.0 ths. m<sup>3</sup>

Total pressure: 4266 Pa

Temperature: 250 C

Efficiency: 84 %

Dustiness: 2.0 g/m<sup>3</sup>

## DIMENSIONS:

Length: 3560 mm

Width: 5350 mm

Height: 4100 mm

Weight: 9030 kg

## ELECTRIC MOTOR:

Power: 400 kW

Rate speed: 750 rpm

Moment of inertia: 1875 kg\*m<sup>2</sup>

AUXILIARIES:

Actuator: 630 Hm

DELIVERY OPTIONS:

Railway: Flatcar: 1 | Open wagon: 0 | Schnabel car: 0

DIMENSIONAL DRAWING:

