

Name: MF-20-EB
Russian name: ВМ-20ДЛ
Type: Mill exhaust fans
Notes: Backward curved blades

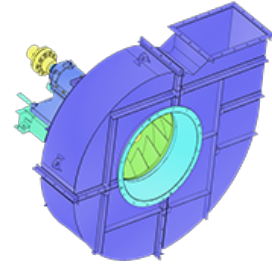

DESCRIPTION:

Mill exhaust fans are designed for nonaggressive non-explosive coal dust pneumatic transport into boiler pulverized-coal system. The design of these fans allows installing them after separators, sizers and collectors under the dustiness up to 80 g/m³. It is also allowed to install such Fans in processing systems for handling nonaggressive gases (The dustiness should be not more than 80 g/m³, abrasion and sticking tendency should be similar to air-pulverized-coal mixture). Mill exhaust fans are single inlet centrifugal fans.

AERODYNAMIC PERFORMANCE:

Capacity: 150.0 ths. m³
Total pressure: 13500 Pa
Temperature: 70 C
Efficiency: 82 %
Dustiness: 80.0 g/m³

DIMENSIONS:

Length: 2760 mm
Width: 3460 mm
Height: 3040 mm
Weight: 5310 kg

ELECTRIC MOTOR:

Power: 800 kW
Rate speed: 1500 rpm
Moment of inertia: 350 kg*m²

AUXILIARIES:

Actuator: 630 Hm

DELIVERY OPTIONS:

Railway: Flatcar: 1 | Open wagon: 0 | Schnabel car: 0

DIMENSIONAL DRAWING:

