

**Name:** MF-22-M  
**Russian name:** BM-22M  
**Type:** Mill exhaust fans  
**Notes:** Radial blades

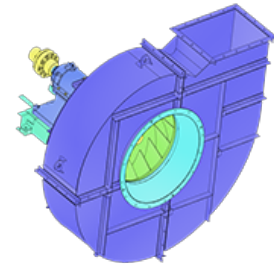

## DESCRIPTION:

Mill exhaust fans are designed for nonaggressive non-explosive coal dust pneumatic transport into boiler pulverized-coal system. The design of these fans allows installing them after separators, sizers and collectors under the dustiness up to 80 g/m<sup>3</sup>. It is also allowed to install such Fans in processing systems for handling nonaggressive gases (The dustiness should be not more than 80 g/m<sup>3</sup>, abrasion and sticking tendency should be similar to air-pulverized-coal mixture). Mill exhaust fans are single inlet centrifugal fans.

## AERODYNAMIC PERFORMANCE:

Capacity: 205.0 ths. m<sup>3</sup>  
Total pressure: 6400 Pa  
Temperature: 200 C  
Efficiency: 72 %  
Dustiness: 80.0 g/m<sup>3</sup>

## DIMENSIONS:

Length: н/д mm  
Width: н/д mm  
Height: н/д mm  
Weight: н/д kg

## ELECTRIC MOTOR:

Power: 630 kW  
Rate speed: 1500 rpm  
Moment of inertia: 716 kg\*m<sup>2</sup>

## AUXILIARIES:

Actuator: 630 Hm

## DELIVERY OPTIONS:

Railway: Flatcar: 1 | Open wagon: 0 | Schnabel car: 0

DIMENSIONAL DRAWING:

