

Name: Return cinder fan
Russian name: BBY-4,3-3000
Type: Return cinder fans
Notes: n/a

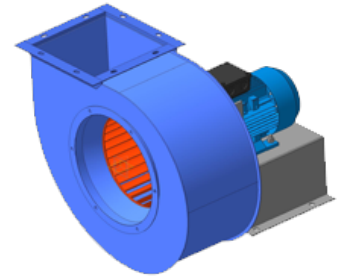

DESCRIPTION:

Return cinder fans are designed for air delivery into return cinder equipment applied in combustion chambers of steam and hot-water solid fuel fired boilers with fuel-bed firing. Return cinder fans are recommended to use in boilers where exhaust flow high speed is required.

AERODYNAMIC PERFORMANCE:

Capacity: 1.0 ths. m³
Total pressure: 3800 Pa
Temperature: 20 C
Efficiency: 52 %
Dustiness: 0.1 g/m³

DIMENSIONS:

Length: 466 mm
Width: 654 mm
Height: 685 mm
Weight: 107,2 kg

ELECTRIC MOTOR:

Power: 4 kW
Rate speed: 3000 rpm
Moment of inertia: н/д kg*m²

AUXILIARIES:

Actuator: н/д Нм

DELIVERY OPTIONS:

Railway: Flatcar: 1 | Open wagon: 0 | Schnabel car: 0

DIMENSIONAL DRAWING:

