

Name: 112-25h1-0m
Type: Pulse valves
Subtype: High parameters valves
Operating medium: steam
Body material: 12X1MΦ

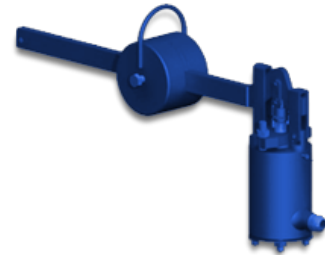

DESCRIPTION:

Pulse valves together with Main safety valves enter into pulse safety device. These valves are designed to control Main safety valves by means of supplying/not supplying the medium into chamber of valve operator.

TECHNICAL DATA:

Diameter, DN: 25 mm
Pressure, PN: 4 MPa
Temperature: 545 СЇ

DIMENSIONS:

D: 130 mm
D1: 100 mm
D2: 58 mm
D3: M16 mm
L: 120 mm
L1: 730 mm
H: 360 mm
H1: 125 mm
H2: н/д mm
A: 40 mm
Weight: 45 кг

DIMENSIONAL DRAWING:

