

Type: Steam boilers
Model: KE type (bituminous / brown coal)
Name: KE-10-14-225S-O
Alias names: KE-10-14-225C-O, E-10-1,4-225P
Fuel: bituminous / brown coal

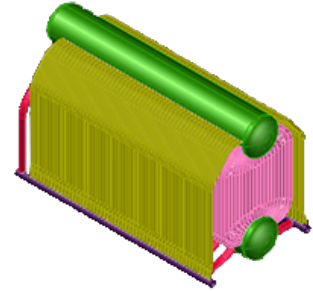

DESCRIPTION:

Steam boilers of this type are designed for production of saturated or overheated steam for needs of different industries, heating, ventilation and hot-water supply systems.

TECHNICAL DATA:

Steam capacity: 10.0 t/h
Output pressure: 1.3 (13) Pa (kp/cm²)
Output temperature: 225 C
Supply water temperature: 100 C
Efficiency: 82,8 %
Fuel consumption: 1140/2250 kg/h

DIMENSIONS:

Integrated boiler dimensions: 8710x5235x 5280 mm
Weight: 20981 kg