

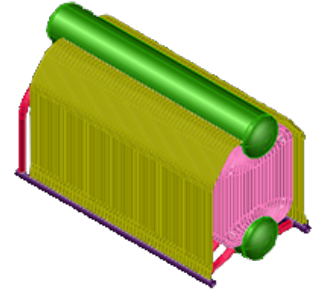

RUSSOL KE-10-14BF (KE-10-14 NTKS)

www.russol.org

Type: Steam boilers
Model: KE type (bituminous / brown coal)
Name: KE-10-14BF (KE-10-14 NTKS)
Alias names: KE-10-14БФ (KE-10-14 HTKC),
E-10-1,4БФ
Fuel: bituminous / brown coal



DESCRIPTION:

Steam boilers of this type are designed for production of saturated or overheated steam for needs of different industries, heating, ventilation and hot-water supply systems.

TECHNICAL DATA:

Steam capacity: 10.0 t/h
Output pressure: 1.3 (13) Pa (kp/cm²)
Output temperature: 194 C
Supply water temperature: 100 C
Efficiency: 81,5 %
Fuel consumption: 2855 kg/h

DIMENSIONS:

Integrated boiler dimensions: 6071X4670X 10430 mm
Weight: 58431 kg