

**Type:** Steam boilers  
**Model:** KE type (wood waste with fuel oil / gas support)  
**Name:** KE-10-14MT-O  
**Alias names:** KE-10-14MT-O, E-10-1,4OГММ  
**Fuel:** wood waste with fuel oil / gas support

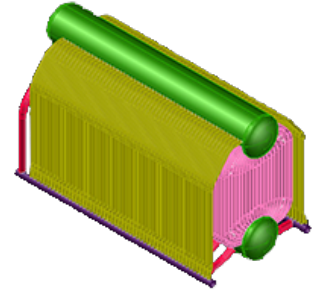

## DESCRIPTION:

Steam boilers of this type are designed for production of saturated or overheated steam for needs of different industries, heating, ventilation and hot-water supply systems.

## TECHNICAL DATA:

Steam capacity: 10.0 t/h  
Output pressure: 1.3 (13) Pa (kp/cm<sup>2</sup>)  
Output temperature: 194 C  
Supply water temperature: 100 C  
Efficiency: 82,6 %  
Fuel consumption: 5474 kg/h

## DIMENSIONS:

Integrated boiler dimensions: 12590x5620x 7490 mm  
Weight: 34600 kg