

**Type:** Steam boilers  
**Model:** KE type (bituminous / brown coal)  
**Name:** KE-16-14-250 NTKS  
**Alias names:** KE-16-14-250 НТКС с топкой кипящего слоя, E-16-1,4-250С  
**Fuel:** bituminous / brown coal

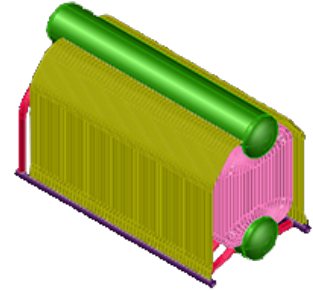

## DESCRIPTION:

Steam boilers of this type are designed for production of saturated or overheated steam for needs of different industries, heating, ventilation and hot-water supply systems.

## TECHNICAL DATA:

Steam capacity: 16.0 t/h  
Output pressure: 1.3 (12,5) Pa (kp/cm<sup>2</sup>)  
Output temperature: 250 C  
Supply water temperature: 100 C  
Efficiency: 89 %  
Fuel consumption: 4921 kg/h

## DIMENSIONS:

Integrated boiler dimensions: 10906x6486x 12027 mm  
Weight: 85400 kg