

Type: Steam boilers
Model: KE type (natural gas / fuel oil)
Name: KE 35-24-370GM
Alias names: KE 35-24-370ГМ, E-35-2,4-370ГМ
Fuel: natural gas / fuel oil

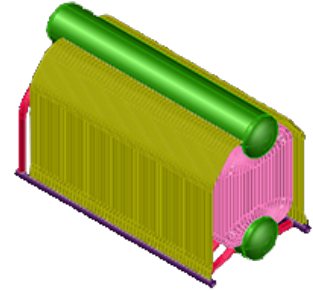

DESCRIPTION:

Steam boilers of this type are designed for production of saturated or overheated steam for needs of different industries, heating, ventilation and hot-water supply systems.

TECHNICAL DATA:

Steam capacity: 35.0 t/h
Output pressure: 2.3 (23) Pa (kp/cm²)
Output temperature: 370 C
Supply water temperature: 100 C
Efficiency: 93,2/91,8 %
Fuel consumption: 3061/2722 kg/h

DIMENSIONS:

Integrated boiler dimensions: 13474X6650X 9550 mm
Weight: 49500 kg