

Name: FDF-13.5C

Russian name: ВД-13,5К

Type: Single inlet centrifugal forced flow fans

Notes: Forward curved blades

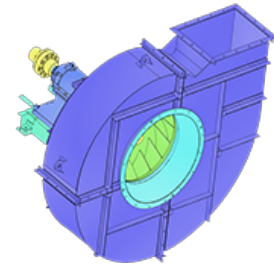

DESCRIPTION:

Single inlet forced-flow fan are intended to be used for air delivery into combustion chamber of boilers. The main parts of such type of fans are: running wheel, guide vanes, scroll case, inlet bell, electric motor, base.

AERODYNAMIC PERFORMANCE:

Capacity: 60.0 ths. m³

Total pressure: 5000 Pa

Temperature: 100 C

Efficiency: 72 %

Dustiness: 0.1 g/m³

DIMENSIONS:

Length: 4098 mm

Width: 2244 mm

Height: 2203 mm

Weight: 2116 kg

ELECTRIC MOTOR:

Power: 132 kW

Rate speed: 1000 rpm

Moment of inertia: 94 kg*m²

AUXILIARIES:

Actuator: 250 Hm

DELIVERY OPTIONS:

Railway: Flatcar: 1 | Open wagon: 0 | Schnabel car: 0

DIMENSIONAL DRAWING:

