

Name: FDF-17.5-FC
Russian name: ВД-17,5ФК
Type: Single inlet centrifugal forced flow fans
Notes: Radial blades

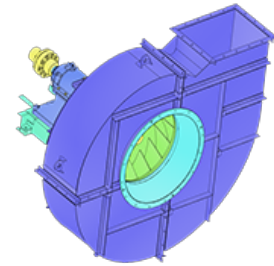

DESCRIPTION:

Single inlet forced-flow fan are intended to be used for air delivery into combustion chamber of boilers. The main parts of such type of fans are: running wheel, guide vanes, scroll case, inlet bell, electric motor, base.

AERODYNAMIC PERFORMANCE:

Capacity: 78.0 ths. m³
Total pressure: 16000 Pa
Temperature: 100 C
Efficiency: 73 %
Dustiness: 0.1 g/m³

DIMENSIONS:

Length: н/д mm
Width: н/д mm
Height: н/д mm
Weight: 3020 kg

ELECTRIC MOTOR:

Power: 500 kW
Rate speed: 1500 rpm
Moment of inertia: 170 kg*m²

AUXILIARIES:

Actuator: 1600 Hm

DELIVERY OPTIONS:

Railway: Flatcar: 1 | Open wagon: 0 | Schnabel car: 0

DIMENSIONAL DRAWING:

