

**Name:** FDF-3-1500

**Russian name:** ВД-3-1500

**Type:** Single inlet centrifugal forced flow fans

**Notes:** Forward curved blades. Running wheel on the electric motor shaft.

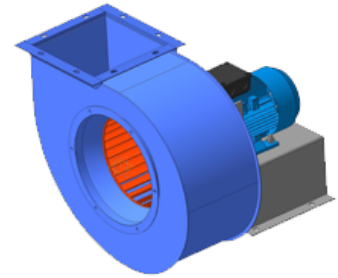

## DESCRIPTION:

Single inlet forced-flow fan are intended to be used for air delivery into combustion chamber of boilers.

## AERODYNAMIC PERFORMANCE:

Capacity: 1.0 ths. m<sup>3</sup>

Total pressure: 460 Pa

Temperature: 70 C

Efficiency: н/д %

Dustiness: 0.1 g/m<sup>3</sup>

## DIMENSIONS:

Length: н/д mm

Width: н/д mm

Height: н/д mm

Weight: 78 kg

## ELECTRIC MOTOR:

Power: 3 kW

Rate speed: 1500 rpm

Moment of inertia: н/д kg\*m<sup>2</sup>

## AUXILIARIES:

Actuator: н/д Нм

## DELIVERY OPTIONS:

Railway: Flatcar: 1 | Open wagon: 0 | Schnabel car: 0

## DIMENSIONAL DRAWING:

