

Name: FDF-HP-20
Russian name: BBH-20
Type: Special purpose FD Fans
Notes: Backward curved blades

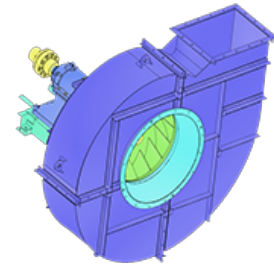

DESCRIPTION:

Mill exhaust fans are designed for nonaggressive non-explosive coal dust pneumatic transport into boiler pulverized-coal system. The design of these fans allows installing them after separators, sizers and collectors under the dustiness up to 80 g/m³. It is also allowed to install such Fans in processing systems for handling nonaggressive gases (The dustiness should be not more than 80 g/m³, abrasion and sticking tendency should be similar to air-pulverized-coal mixture). Mill exhaust fans are single inlet centrifugal fans.

AERODYNAMIC PERFORMANCE:

Capacity: 150.0 ths. m³
Total pressure: 13500 Pa
Temperature: 70 C
Efficiency: 80 %
Dustiness: 10.0 g/m³

DIMENSIONS:

Length: 3200 mm
Width: 3450 mm
Height: 3040 mm
Weight: 5 010 kg

ELECTRIC MOTOR:

Power: 800 kW
Rate speed: 1500 rpm
Moment of inertia: 400 kg*m²

AUXILIARIES:

Actuator: 630 Hm

DELIVERY OPTIONS:

Railway: Flatcar: 1 | Open wagon: 0 | Schnabel car: 0

DIMENSIONAL DRAWING:

