

**Name:** FDFB-20

**Russian name:** ВДН-20

**Type:** Single inlet centrifugal FD fans of FDFB type

**Notes:** Backward curved blades

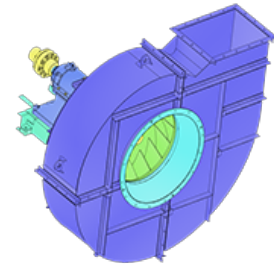

## DESCRIPTION:

Single inlet centrifugal FD Fans are used for air delivery into combustion chambers of boilers with the capacity of 2.5- 950 t/h operating with balanced draft (secondary blast). It is allowed to use these fans in processing systems to handle air with the temperature not more than 70 °C. Single inlet centrifugal FD Fans can have right-hand or left-hand rotational direction. The right-hand rotation is in a clockwise order and it should be defined at electric motor side. The main units of Single inlet centrifugal FD Fan are: running wheel, running gear, scroll casing, inlet bell and axial guide vanes. The blades of impeller are backward curved.

## AERODYNAMIC PERFORMANCE:

Capacity: 215.0 ths. m<sup>3</sup>

Total pressure: 4710 Pa

Temperature: 100 C

Efficiency: 87 %

Dustiness: 0.1 g/m<sup>3</sup>

## DIMENSIONS:

Length: 3520 mm

Width: 4710 mm

Height: 3840 mm

Weight: 5 660 kg

## ELECTRIC MOTOR:

Power: 400 kW

Rate speed: 1000 rpm

Moment of inertia: 500 kg\*m<sup>2</sup>

## AUXILIARIES:

Actuator: 630 Hm

DELIVERY OPTIONS:

Railway: Flatcar: 1 | Open wagon: 0 | Schnabel car: 0

DIMENSIONAL DRAWING:

