

Name: FDFB-9-RG-1000

Russian name: ВДН-9Х-1000

Type: Single inlet centrifugal FD fans of FDFB type

Notes: Backward curved blades

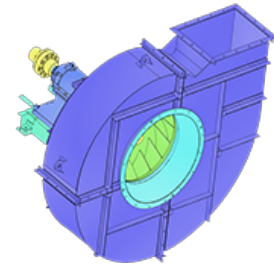

DESCRIPTION:

Single inlet centrifugal FD Fans are used for air delivery into combustion chambers of boilers with the capacity of 2.5- 950 t/h operating with balanced draft (secondary blast). It is allowed to use these fans in processing systems to handle air with the temperature not more than 70 °C. Single inlet centrifugal FD Fans can have right-hand or left-hand rotational direction. The right-hand rotation is in a clockwise order and it should be defined at electric motor side. The blades of impeller are backward curved.

AERODYNAMIC PERFORMANCE:

Capacity: 9.9 ths. m³

Total pressure: 1250 Pa

Temperature: 30 C

Efficiency: 83 %

Dustiness: 0.1 g/m³

DIMENSIONS:

Length: 2200 mm

Width: 1647 mm

Height: 1345 mm

Weight: 720 kg

ELECTRIC MOTOR:

Power: 11 kW

Rate speed: 1000 rpm

Moment of inertia: 9,15 kg*m²

AUXILIARIES:

Actuator: 100 Hm

DELIVERY OPTIONS:

Railway: Flatcar: 1 | Open wagon: 0 | Schnabel car: 0

DIMENSIONAL DRAWING:

