

Name: IDFB-15-SS
Russian name: ДН-15НЖ
Type: Special purpose ID Fans
Notes: Backward curved blades

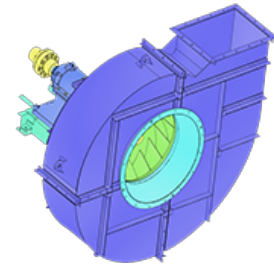

DESCRIPTION:

Centrifugal ID Fans made of stainless steel are designed for removal of sulfur-containing and dust-loaded flue gases from metallurgical concentrate furnaces widely used in nonferrous metallurgy, chemical industry and fertilizer manufacturing. The handling gases should contain up to 11% of SO₂ under 40°C temperature and dustiness not more than 2 g/m³. In view of high aggressivity of handling flue gases such ID Fans are manufactured in corrosion-resistant design. The ID Fans of this modification have no inlet boxes. The blades of impeller are backward curved.

AERODYNAMIC PERFORMANCE:

Capacity: 77.5 ths. m³
Total pressure: 3653 Pa
Temperature: 400 C
Efficiency: 85 %
Dustiness: 1.0 g/m³

DIMENSIONS:

Length: 2760 mm
Width: 2940 mm
Height: 2300 mm
Weight: 2508 kg

ELECTRIC MOTOR:

Power: 110 kW
Rate speed: 1500 rpm
Moment of inertia: 110 kg*m²

AUXILIARIES:

Actuator: 630 Hm

DELIVERY OPTIONS:

Railway: Flatcar: 1 | Open wagon: 0 | Schnabel car: 0

DIMENSIONAL DRAWING:

