

Name: IDFB-17-RG-750

Russian name: ДН-17Х-750

Type: Single inlet centrifugal ID fans of IDFB type

Notes: Backward curved blades

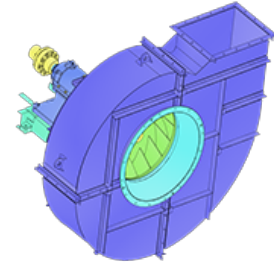

DESCRIPTION:

Single inlet centrifugal ID Fans are intended to be used for flue gas removal from combustion chambers of solid fuel or gas-and-oil-fired boilers equipped with dry ash catchers. It is allowed to install such ID Fans in processing systems for handling compatible gases (The dustiness should be not more than 2 g/m³, abrasion and sticking tendency should be similar to ashed flue gases). Such ID Fans can be applied for single or serial-parallel operation. Double inlet centrifugal ID Fans can have right-hand or left-hand rotational direction. The right-hand rotation is in a clockwise order and it should be defined at electric motor side. The main units of Single inlet centrifugal ID Fan are: running wheel, running gear, scroll casing, inlet bell and axial guide vanes. The blades of impeller are backward curved.

AERODYNAMIC PERFORMANCE:

Capacity: 56.6 ths. m³
Total pressure: 1850 Pa
Temperature: 200 C
Efficiency: 84 %
Dustiness: 2.0 g/m³

DIMENSIONS:

Length: 3367 mm
Width: 3187 mm
Height: 2524 mm
Weight: 3142 kg

ELECTRIC MOTOR:

Power: 55 kW
Rate speed: 750 rpm
Moment of inertia: 167,5 kg*m²

AUXILIARIES:

Actuator: 630 Hm

DELIVERY OPTIONS:

Railway: Flatcar: 1 | Open wagon: 0 | Schnabel car: 0

DIMENSIONAL DRAWING:

