

**Name:** IDFB-24-F-C

**Russian name:** ДН-24ФК

**Type:** Single inlet centrifugal high pressure ID fans

**Notes:** Backward curved blades

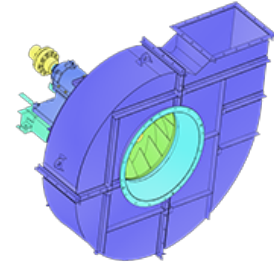

## DESCRIPTION:

Single inlet high-pressure ID Fans are designed for flue gas removal from combustion chambers of steam boilers with the capacity of up to 480 t/h with increased resistance of flue gas path. It is also allowed to install such ID Fans in processing systems for handling compatible gases (The dustiness should be not more than 2 g/m<sup>3</sup>, abrasion and sticking tendency should be similar to ashed flue gases). Also these fans are recommended to handle gases containing trace elements with sticking tendency. The blades of impeller are backward curved.

## AERODYNAMIC PERFORMANCE:

Capacity: 157.3 ths. m<sup>3</sup>

Total pressure: 5760 Pa

Temperature: 250 C

Efficiency: 78 %

Dustiness: 2.0 g/m<sup>3</sup>

## DIMENSIONS:

Length: 3485 mm

Width: 4820 mm

Height: 3840 mm

Weight: 8000 kg

## ELECTRIC MOTOR:

Power: 400 kW

Rate speed: 750 rpm

Moment of inertia: 1125 kg\*m<sup>2</sup>

## AUXILIARIES:

Actuator: 630 Hm

## DELIVERY OPTIONS:

Railway: Flatcar: 1 | Open wagon: 0 | Schnabel car: 0

DIMENSIONAL DRAWING:

