

**Name:** IDFB-8-RG-1500  
**Russian name:** ДН-8Х-1500  
**Type:** Single inlet centrifugal ID fans of IDFB type  
**Notes:** Backward curved blades

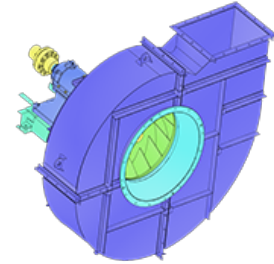

## DESCRIPTION:

Single inlet centrifugal ID Fans are intended to be used for flue gas removal from combustion chambers of solid fuel or gas-and-oil-fired boilers equipped with dry ash catchers. It is allowed to install such ID Fans in processing systems for handling compatible gases (The dustiness should be not more than 2 g/m<sup>3</sup>, abrasion and sticking tendency should be similar to ashed flue gases). Such ID Fans can be applied for single or serial-parallel operation. Double inlet centrifugal ID Fans can have right-hand or left-hand rotational direction. The right-hand rotation is in a clockwise order and it should be defined at electric motor side. The blades of impeller are backward curved.

## AERODYNAMIC PERFORMANCE:

Capacity: 10.5 ths. m<sup>3</sup>  
Total pressure: 1430 Pa  
Temperature: 200 C  
Efficiency: 83 %  
Dustiness: 2.0 g/m<sup>3</sup>

## DIMENSIONS:

Length: 2160 mm  
Width: 1470 mm  
Height: 1265 mm  
Weight: 681 kg

## ELECTRIC MOTOR:

Power: 15 kW  
Rate speed: 1500 rpm  
Moment of inertia: 6,65 kg\*m<sup>2</sup>

## AUXILIARIES:

Actuator: 100 Hm

DELIVERY OPTIONS:

Railway: Flatcar: 1 | Open wagon: 0 | Schnabel car: 0

DIMENSIONAL DRAWING:

